

Chukchi Campus: UAF

Anchor Institutions: Workforce Development





Chukchi Campus:

Anchor Institution for Northwest Arctic Borough, Alaska



Kotzebue, AK:

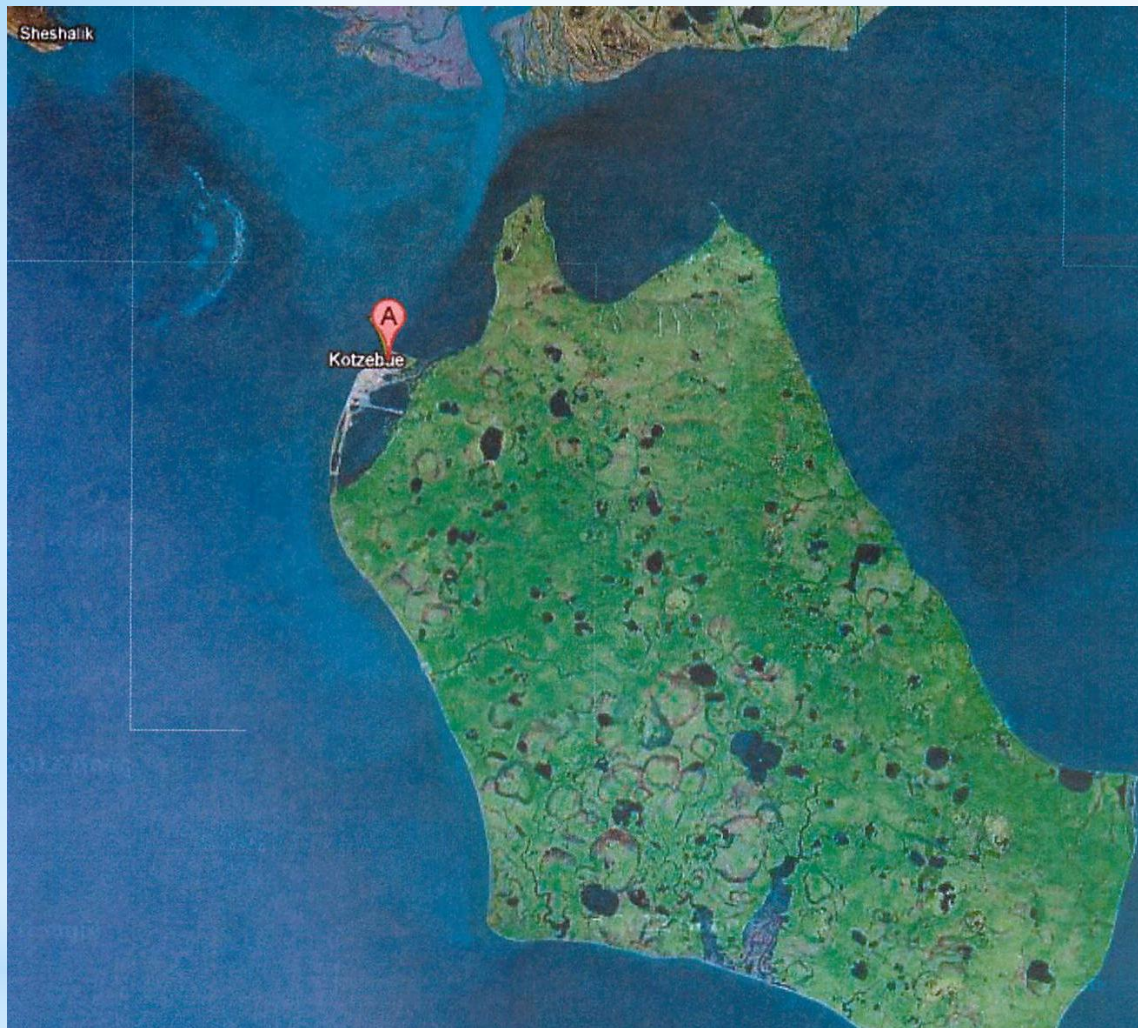

Baldwin Peninsula



Northwest Arctic Borough

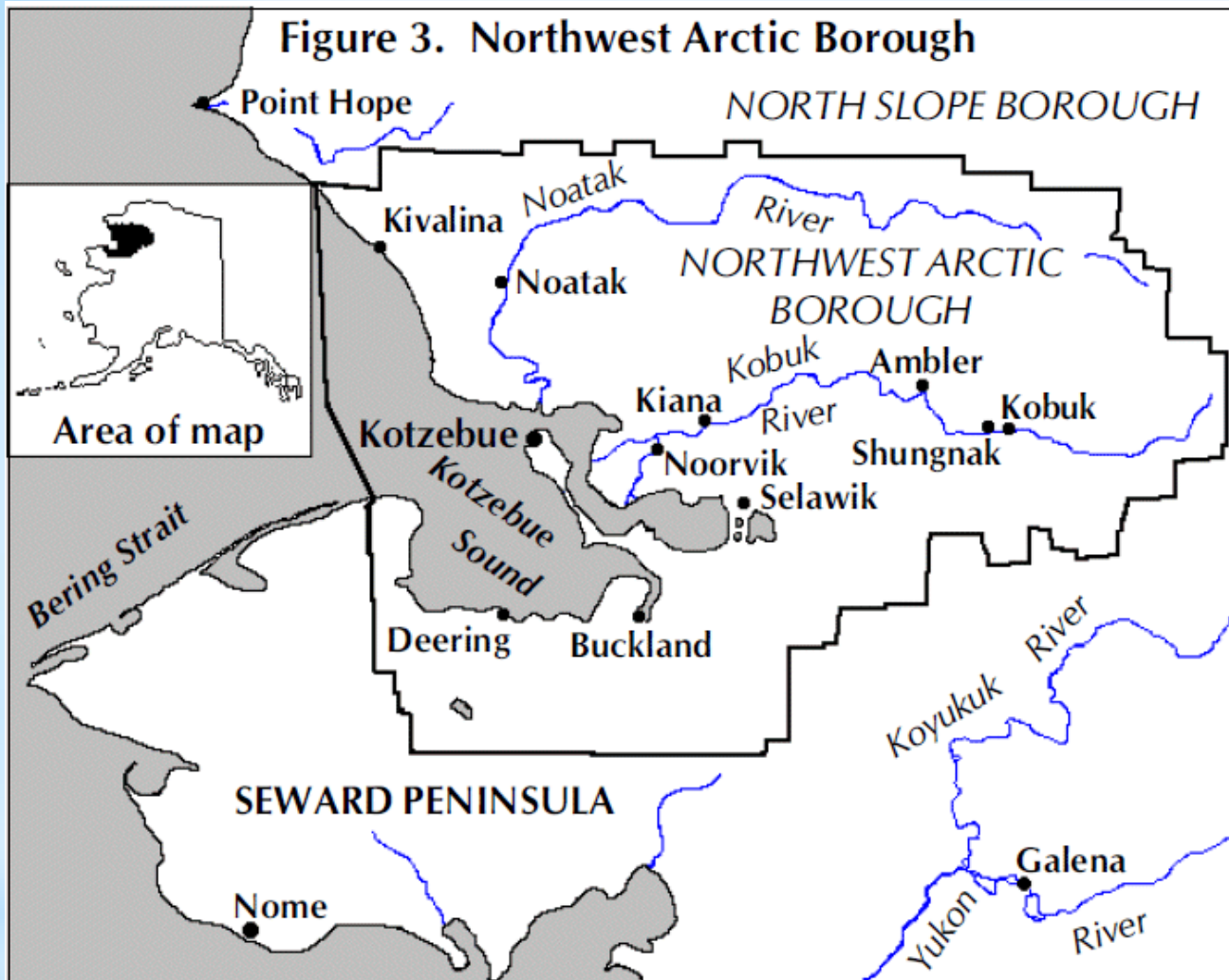

**Chukchi Campus: Serves Kotzebue
and 10 Outlying Villages in NWAB**





* Remote and mostly roadless

* Water transportation limited from fall (September-October) ice-up until spring (May-June) break-up.

* Heavily dependent on air travel which grows ever more expensive.

* If something isn't barged in during summer, it's flown in.

* **Alaska is expensive**
Rural Alaska... even more so

Alaska's size relative to the continental United States



These two maps are projected in an Equal Area projection appropriate for their global location.
Both maps are projected at a base scale of 1:118,490,830.

For more information about this map, please contact webinfo@alaska.edu

Produced by the UAF Geographic Information Network of Alaska
(www.gina.alaska.edu)



Some Perspective on Shipping Costs

Monthly Heating Oil Cost depending on quality of home construction
(Kotzebue prices, villages without summer barge service face much higher costs)

	Average Construction	Poorly Insulated Construction
Stove Oil gal /winter month	130	600
Price of Stove Oil in Kotzebue 2012*	\$6.30/gal*	\$6.30/gal*
Cost of one month of heat	\$819	\$3780

***The High Cost of Fuel
to Heat Homes**

* Defining Subsistence: “customary and traditional uses of wild resources for food, clothing, fuel, transportation, construction, arts, crafts, sharing, and customary trade.”



* Mixed
Subsistence-
Cash Economy

Wild food harvests in Alaska: Nutritional and replacement values

	Annual wild food harvest (pounds per person)	Annual wild food harvest (total pounds usable weight)	Percent of population's required:		Estimated wild food replacement value at \$3.50/pound	Estimated wild food replacement value at \$7/pound
			Protein (51 grams/day) (without plants)	Calories (2,250 calories/day) (without plants)		
Rural areas						
Southcentral	180	1,318,594	105%	18%	\$4,615,080	\$9,230,160
Kodiak Island	161	1,190,412	94%	16%	\$7,666,442	\$15,332,884
Southeast	217	1,622,745	122%	21%	\$20,400,751	\$40,801,502
Southwest-Aleutian	212	1,429,130	121%	21%	\$12,001,955	\$24,003,910
Interior	370	2,814,740	221%	36%	\$12,815,971	\$25,631,942
Arctic	436	10,592,409	247%	42%	\$37,073,432	\$74,146,864
Western	316	2,429,272	155%	31%	\$9,491,319	\$18,982,638
Total rural	316	38,304,272	155%	31%	\$134,064,951	\$268,129,902
Urban areas						
Chitikan area	36	482,607	22%	3%	\$1,689,123	\$3,378,246
Kenai area	27	848,291	17%	3%	\$2,969,019	\$5,938,038
Matanuska-Susitna area	27	2,413,553	17%	3%	\$8,447,434	\$16,894,868
Fairbanks-Delta	22	2,247,598	13%	2%	\$7,866,595	\$15,733,190
Kenai Peninsula	45	1,190,412	24%	5%	\$8,515,971	\$17,031,942
Anchorage area	17	1,190,412	24%	2%	\$7,735,084	\$15,470,168
Valdez	50	200,247	31%	5%	\$700,864	\$1,401,728
Cordova Bay	23	50,788	11%	2%	\$177,758	\$355,516
Total urban	23	13,761,370	11%	2%	\$48,344,444	\$96,688,888
Alaska total	73	52,114,490	43%	7%	\$182,400,714	\$364,801,422

* Annual Pounds per person 316

* 31% of Calories a day

* Replacement value at \$3.50/lb = @ \$1,106

* Replacement value at \$7.00/lb = @ \$2,212

* **Avg. Rural Alaska Wild Food Harvest Value**

*Cash Sector

- *Unstable and seasonal, low absolute value
- *Much of cash is invested into maintaining subsistence activities

Freezers

SNOW MACHINE

Ice auger

GAS

WINTER WEATHER GEAR

BOAT & ENGINE

4-wheeler

*Mixed Subsistence-Cash
Economy

Knives, guns, nets,
ammo, hooks, floats,
tools

* Rural jobs often taken by trained people from outside rural Alaska

* Teachers

* Health workers

* Government agencies

* Law enforcement

* Expensive, high turnover rates, not well tied to the region

*** Workforce Development for Rural Residents to Get Jobs**

HUD OUP and Chukchi Campus

- * HUD OUP has assisted Chukchi Campus in bringing education and workforce development to the Northwest Arctic Borough
- * Chukchi Campus has completed 3 HUD OUP grant supported projects and we are in the middle of our 4th.

From Earliest Project...

- * HUD OUP and Chukchi have focused on workforce development in construction and maintenance

Sulainich Arts Center



*Sulainich Arts Center

Direct workforce development of carpentry skills for renovation breeds ongoing economic benefits creating a space for art and craft production and sales



Workspace



Showroom

HUD OUP and Chukchi Campus

- * Workforce development = KEY component of these activities.
- * Construction and Maintenance work
 - * one of few paid employment opportunities in rural Alaska
 - * Increased training opportunities, particularly attractive for young males in the region
 - * High demand for new construction, weatherization, repairs, maintenance





*Construction and
Maintenance - in high
demand

Partners in Workforce Development

- * Partnerships with community, regional, state, and federal agencies.



The Northwest Inupiat Housing Authority (NIHA)



- *Link Fairbanks's Cold Climate Housing Research Center to local housing authority.

- *Design a prototype high efficiency arctic home.

- *Train in new techniques and equipment

- *Trainees construct prototype home with oversight of housing authority

- ***Current Project:**

- Tuppiñialiq Alapaanuruami
(Building our Arctic Home)**



*Buckland, AK

*Community Involvement and Consultation



* 10 trainees from
Buckland trained
in construction at
Alaska Technical
Center



LOWER THE CORNERS

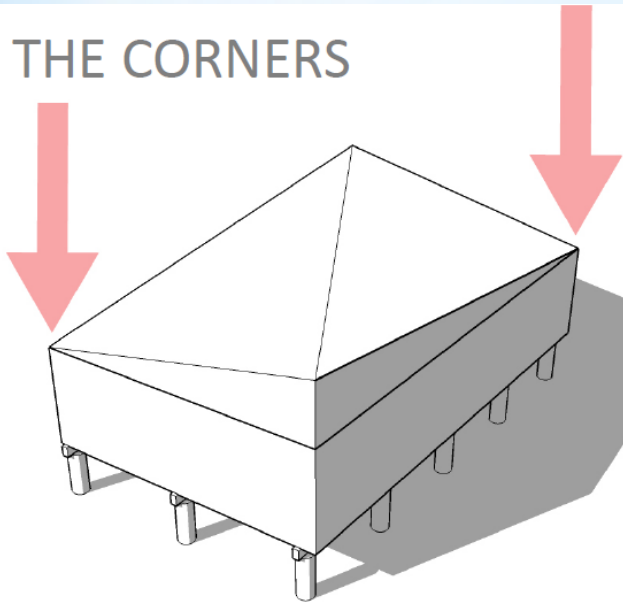

- The prototype:

- Efficient, healthy, dry & safe home
- Seeks community input and guidance
- Research and testing of new methods
- Acknowledges the high costs of energy

PREFABRICATED TRUSSES

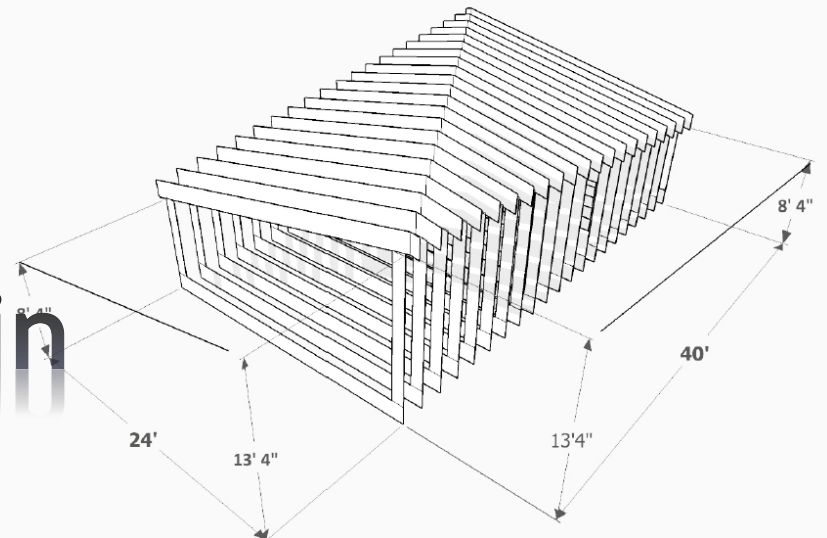

* Design from Cold Climate Housing Research Center in Fairbanks

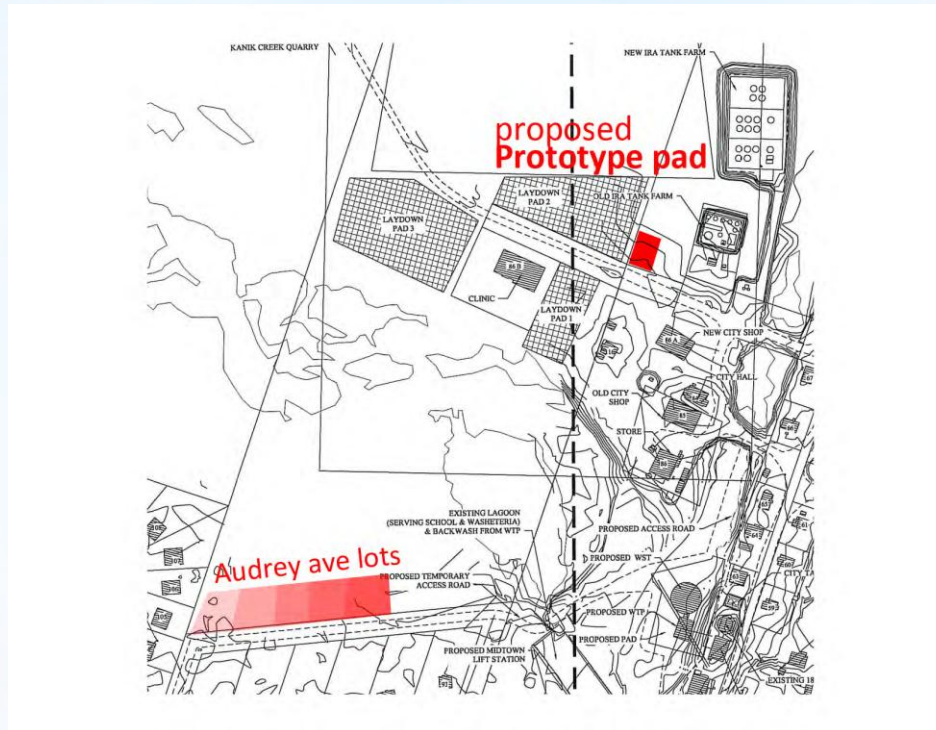

*Current status:
Environmental Review,
Permits and Planning

*How do you measure success in Rural Alaska?

*Very small population density

* Population of Louisiana 4,574,000 vs. Population of Alaska 710,000

* Population of New Orleans 343,829 vs. Population of NWAB 7,523

* Mixed Subsistence - cash economy where success is not always characterized as a full time job

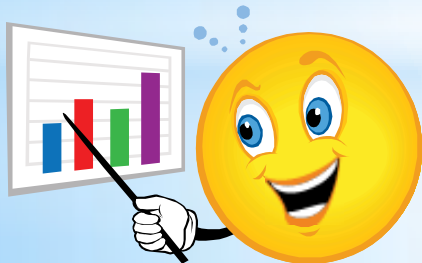

*Measuring Impact of HUD OUP Program at Chukchi

*Finishing training



*Contextually Relevant
Measures of Success

* Continuing on to additional training and education



* Contextually Relevant Measures of Success

* Full time jobs in construction or maintenance



* Contextually Relevant
Measures of Success

* Seasonal or occasional cash employment



* Contextually Relevant
Measures of Success

- * Informal work on extended family and community projects.

- * Fish Camp

- * Weatherization

- * Repairs



- * Contextually Relevant Measures of Success

*Increased self-worth and importance
as role models



*Contextually Relevant
Measures of Success



*Questions?